

profile

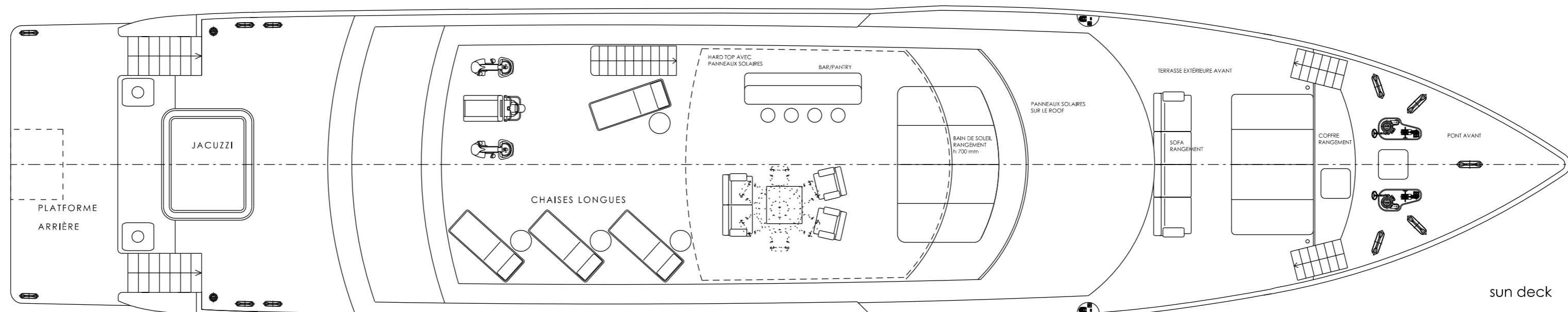

sun deck

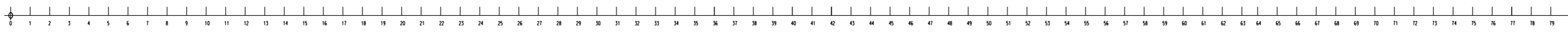
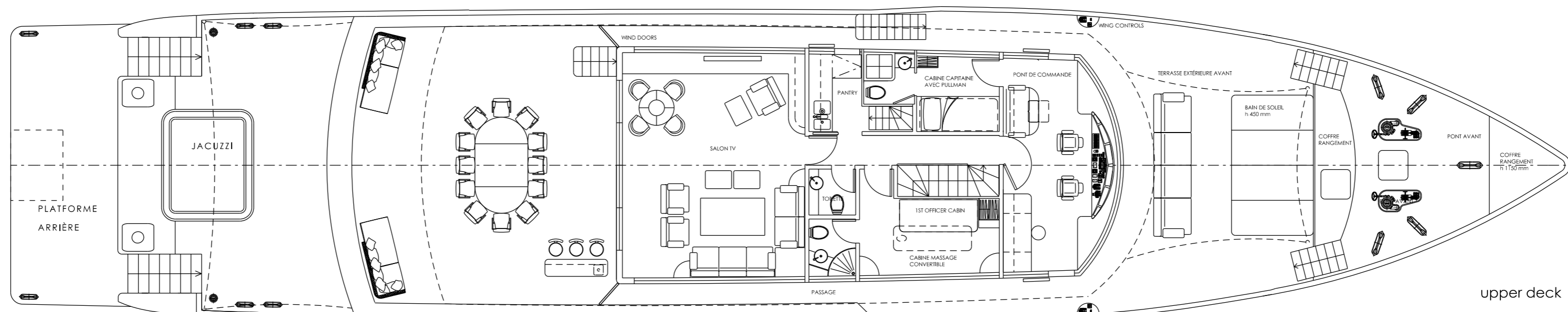

upper deck

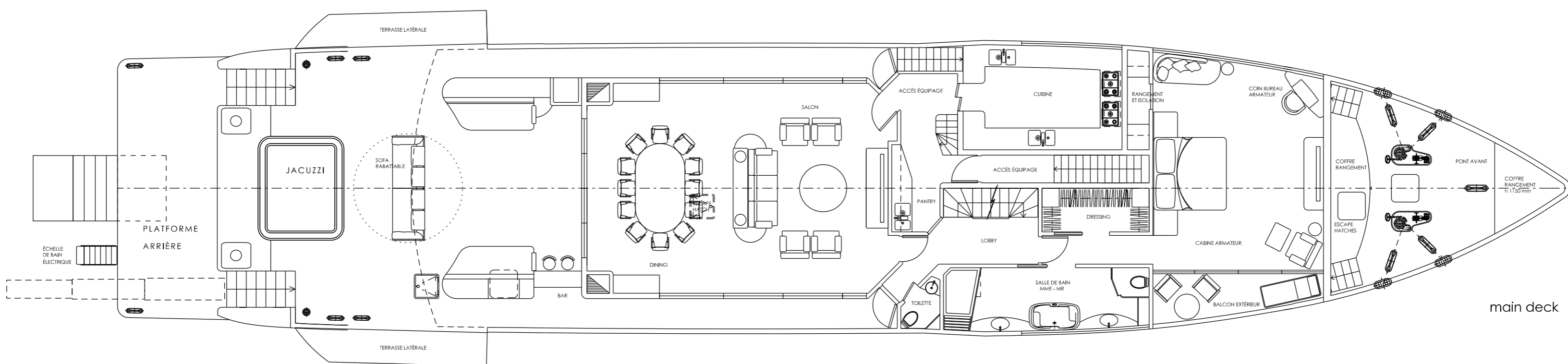

main deck

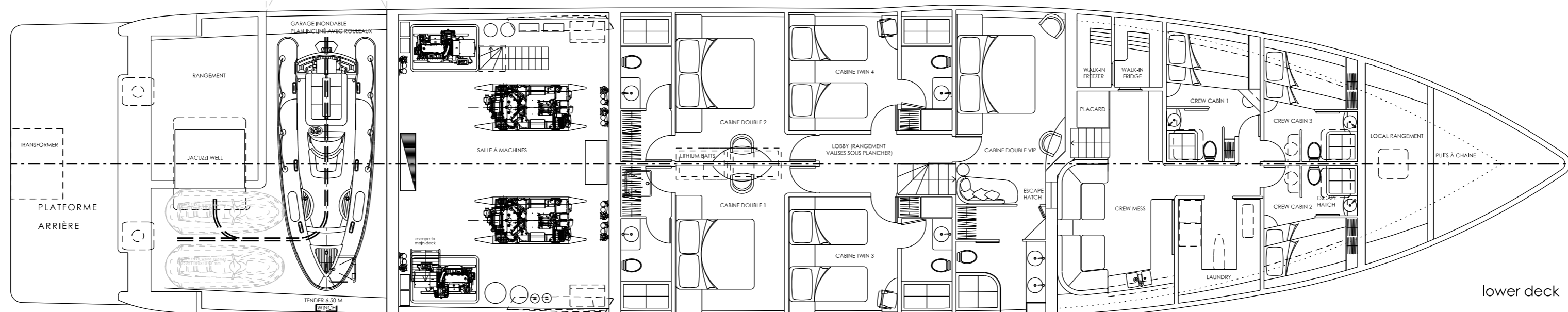

lower deck

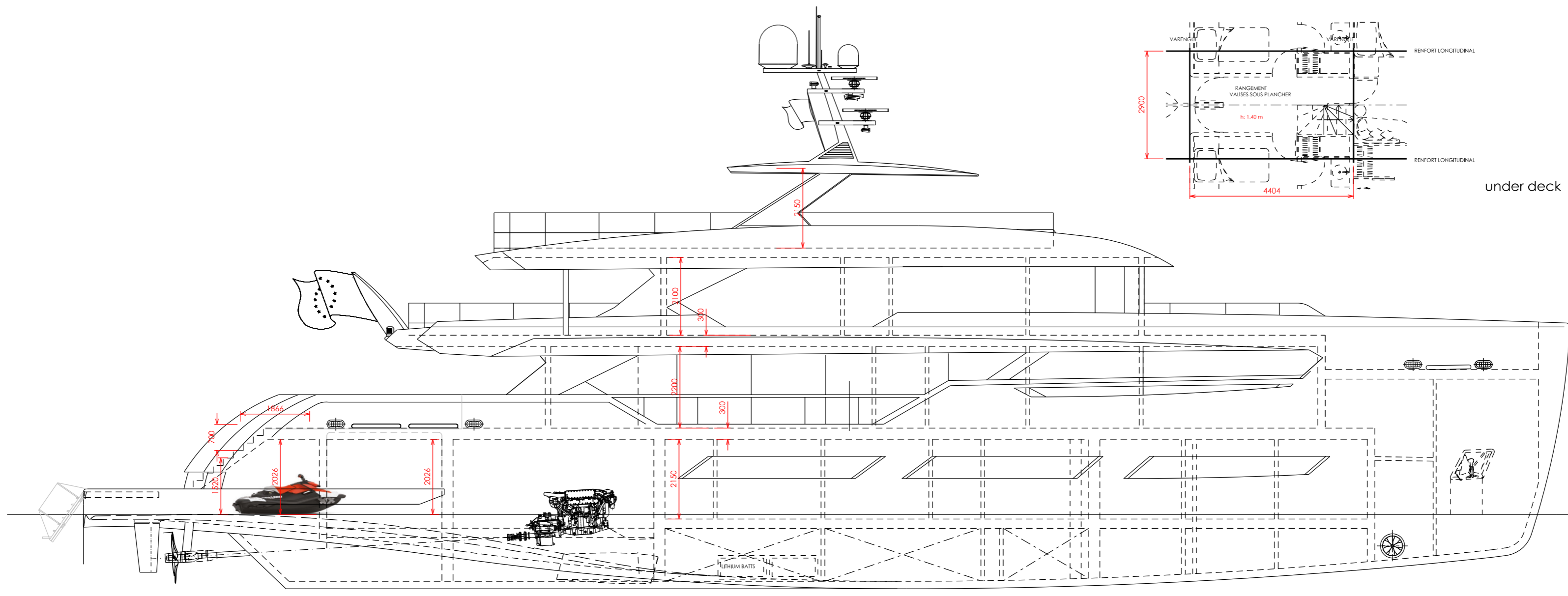

under deck

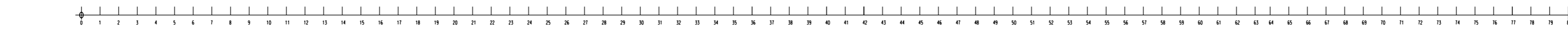

Overall length:	40.00 m	Cruising speed:	14 kn	Fuel tanks capacity:	30 m3	Waste oil tank capacity:	2 m3
Length waterline:	39.12 m	Maximum speed:	15 kn	Fresh Water tanks capacity:	6 m3	Bilge water tank capacity:	2 m3
Maximum beam:	8.15 m	Range (at cruising speed):	2600 nm	Lub-oil tank capacity:	2 m3	Grey & Black Water tank capacity:	4 m3
Draft:	2.00 m	Range (at 12 kn):	+3500 nm	Hydraulic oil tank capacity:	1 m3	Stabilizers:	Zero Speed
Displacement lightship :	210 ton	Engines:ZAMAN V8 1000hp/735kW@2300rpm-SCR		EV 1#HULL YACHT,Charter Yacht-Motor-S,ZE,PM,		Bow thruster	50kW
Gross tonnage:	349 GT	Hybrid system: Lithium batteries & electric motors		Unrestricted Navigation,AUT-UMS,Reg Code Part A		HR Steel hull / Carbon fibre superstructure	
		Generators:	2x KOHLER 70 kW @ 1500 rpm	12 Guests in 6 cabins / up to 8 Crew in 4 cabins		Tender on garage:	LOA up to 6.5m

	Project:	40.00m Motor Yacht	Drawing No.:	40.00MY-001-02-F0
	Title:	General Arrangement	Date:	06/06/24
	For:	Cantieri di Pisa	Project No.:	576
	dgn:	40.00mMotorYacht-GA00	Revision No.:	02
© Marcelo Penna Yacht Design		Av. Sàbria 143 - 1ª 1ª	08005 Barcelona	